

INSTALLATION OF THIS PRODUCT IN THE HVHZ AREA REQUIRES THE USE OF APPROVED SHUTTERS OR EXTERNAL PROTECTION DEVICES COMPLYING WITH HVHZ REQUIREMENTS.  
 INSTALLATION OF THIS SYSTEM OUTSIDE THE HVHZ AREA SHALL MEET THE APPLICABLE REQUIREMENTS FOR WIND BORNE DEBRIS PROTECTION.

**SERIES 580 ALUMINUM SINGLE HUNG WINDOW**

DESIGN LOAD RATINGS FOR THESE WINDOWS TO BE AS PER CHARTS SHOWN ON SHEET 2.

APPROVAL APPLIES TO SINGLE UNITS OR SIDE BY SIDE COMBINATIONS OF S.H./S.H. OR S.H. WITH OTHER WINDOW TYPES IN MODULES OF TWO OR MORE WINDOWS USING F.B.C. APPROVED MULLIONS IN BETWEEN.

LOWER DESIGN PRESSURE FROM WINDOW OR MULLION APPROVAL WILL APPLY TO ENTIRE SYSTEM.

THIS PRODUCT HAS BEEN DESIGNED AND TESTED TO COMPLY WITH THE REQUIREMENTS OF THE 2020 (7TH EDITION) FLORIDA BUILDING CODE INCLUDING HIGH VELOCITY HURRICANE ZONE (HVHZ).

1BY OR 2BY WOOD BUCKS & BUCK FASTENERS BY OTHERS, MUST BE DESIGNED AND INSTALLED ADEQUATELY TO TRANSFER APPLIED PRODUCT LOADS TO THE BUILDING STRUCTURE.

ANCHORS SHALL BE CORROSION RESISTANT, SPACED AS SHOWN ON DETAILS AND INSTALLED PER MANUF'S INSTRUCTIONS. SPECIFIED EMBEDMENT TO BASE MATERIAL SHALL BE BEYOND WALL DRESSING OR STUCCO.

A LOAD DURATION INCREASE IS USED IN DESIGN OF ANCHORS INTO WOOD ONLY.

ALL SHIMS TO BE HIGH IMPACT, NON-METALLIC AND NON-COMPRESSIBLE.

MATERIALS INCLUDING BUT NOT LIMITED TO STEEL/METAL SCREWS, THAT COME INTO CONTACT WITH OTHER DISSIMILAR MATERIALS SHALL MEET THE REQUIREMENTS OF THE 2020 FLORIDA BLDG. CODE & ADOPTED STANDARDS.

THIS PRODUCT APPROVAL IS GENERIC AND DOES NOT PROVIDE INFORMATION FOR A SITE SPECIFIC PROJECT, i.e. LIFE SAFETY OF THIS PRODUCT, ADEQUACY OF STRUCTURE RECEIVING THIS PRODUCT AND SEALING AROUND OPENING FOR WATER INFILTRATION RESISTANCE ETC.

CONDITIONS NOT SHOWN IN THIS DRAWING ARE TO BE ANALYZED SEPARATELY, AND TO BE REVIEWED BY BUILDING OFFICIAL.

DESIGN LOADS SHOWN ARE BASED ON 'ALLOWABLE STRESS DESIGN (ASD)'.

MANUFACTURER'S LABEL SHALL BE LOCATED ON A READILY VISIBLE LOCATION IN ACCORDANCE WITH SECTION 1709.9.3 OF FLORIDA BUILDING CODE. LABELING TO COMPLY WITH SECTION 1709.9.2.

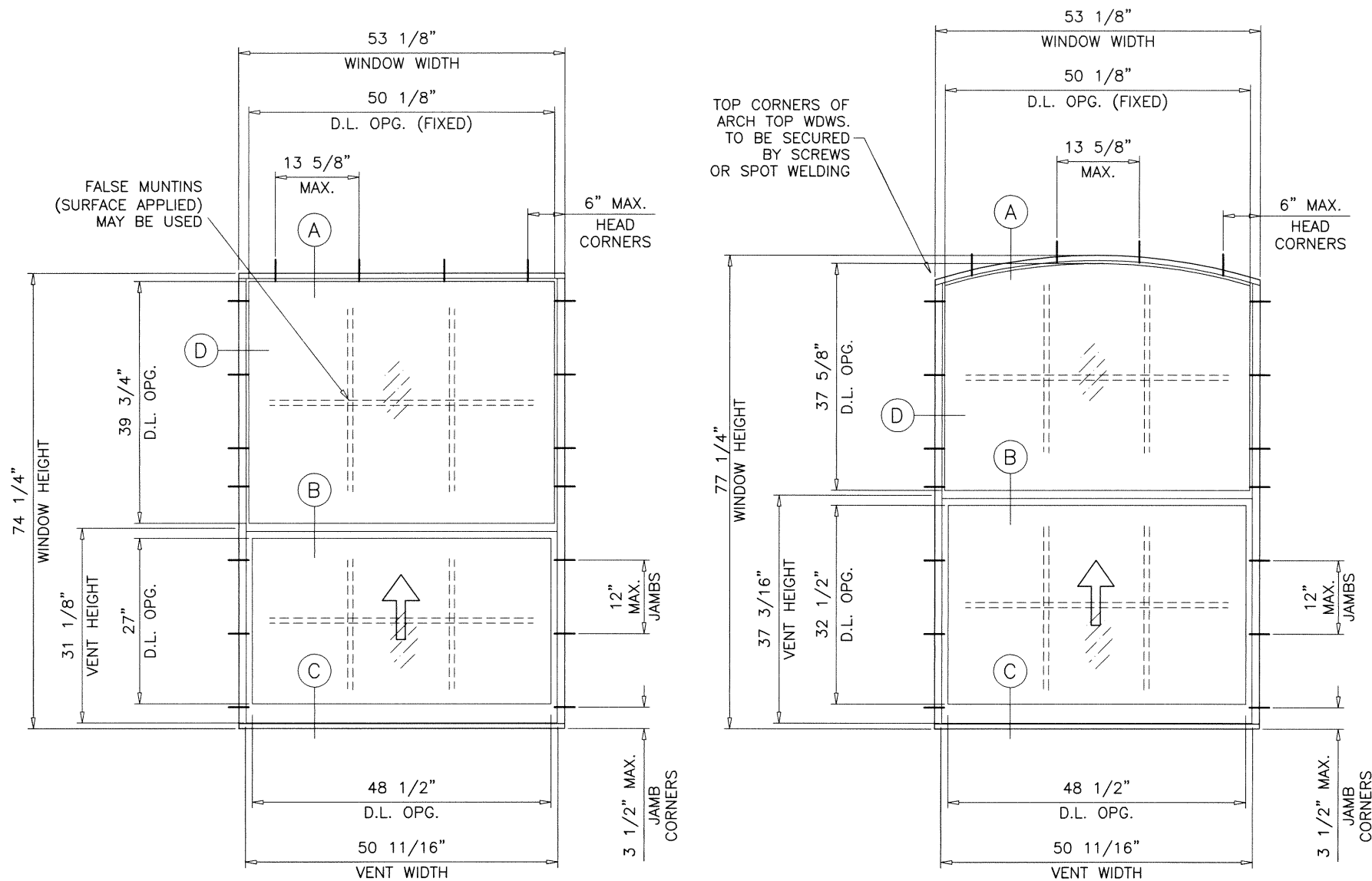

**TYPICAL ELEVATION**

TESTED UNITS

**MONOLITHIC GLASS  
 INSULATING GLASS  
 NON IMPACT**

Sealed: 1/29/2021

FL #21857

- A- CONTRACTOR TO BE RESPONSIBLE FOR THE SELECTION, PURCHASE AND INSTALLATION OF THIS PRODUCT BASED ON THIS PRODUCT EVALUATION PROVIDED HE/SHE DOES NOT DEVIATE FROM THE CONDITIONS DETAILED ON THIS DOCUMENT.
- B- THIS PRODUCT EVALUATION DOCUMENT WILL BE CONSIDERED INVALID IF ALTERED BY ANY MEANS.
- C- SITE SPECIFIC PROJECTS SHALL BE PREPARED BY A FLORIDA REGISTERED ENGINEER OR ARCHITECT WHICH WILL BECOME THE ENGINEER OF RECORD (E.O.R.) FOR THE PROJECT AND WHO WILL BE RESPONSIBLE FOR THE PROPER USE OF THE P.E.D. ENGINEER OF RECORD, ACTING AS A DELEGATED ENGINEER TO THE P.E.D. ENGINEER SHALL SUBMIT TO THIS LATTER THE SITE SPECIFIC DRAWINGS FOR REVIEW.
- D- THIS P.E.D. SHALL BEAR THE DATE AND ORIGINAL SEAL AND SIGNATURE OF THE PROFESSIONAL ENGINEER OF RECORD THAT PREPARED IT.

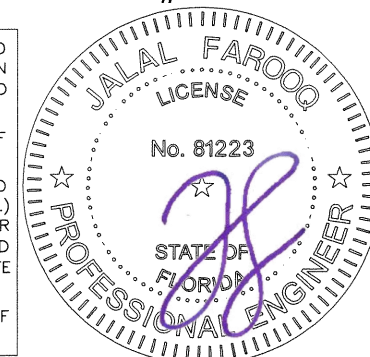

**af c**  
**AL-FAROOQ CORPORATION**  
 ENGINEERS & PRODUCT DEVELOPMENT  
 9360 SUNSET DRIVE, SUITE 220 (C.A.N. 3538)  
 MIAMI, FLORIDA 33173 TEL. (305) 264-8100 FAX. (305) 262-6978  
 COMP-ANL\W17-19AMP

SERIES 580 ALUM SINGLE HUNG WINDOW (N.I.)  
**Assura Windows & Doors, LLC**  
 d/b/a AWP Windows & Doors  
 1543 N. Powerline Road  
 Pompano Beach, Fl. 33069  
 Tel. (305) 887-2646 Fax. (-)

no	date	description
A	10.03.17	UPDATED TO 2017 FBC
B	01.28.21	UPDATED TO 2020 FBC

date: 02-13-17  
 scale: 1/2"=1'-0"  
 dr. by: TARIQ  
 chk. by:

drawing no.  
**W17-19**  
 sheet 1 of 5

DESIGN LOAD CAPACITY - PSF								
WINDOW DIMS.		GLASS TYPE 'A'		GLASS TYPE 'B'		GLASS TYPE 'C'		
WIDTH	HEIGHT	EXT.(+)	INT.(-)	EXT.(+)	INT.(-)	EXT.(+)	INT.(-)	
19-1/8"	26"	60.0	80.0	60.0	125.0	60.0	210.0	
26-1/2"		60.0	80.0	60.0	125.0	60.0	179.7	
37"		60.0	80.0	60.0	112.9	60.0	112.9	
42"		(3)	60.0	79.3	60.0	95.9	60.0	95.9
48"		52.7	52.7	60.0	81.3	60.0	81.3	
53-1/8"		38.6	38.6	60.0	71.9	60.0	71.9	
19-1/8"	38-3/8"	60.0	80.0	60.0	125.0	60.0	210.0	
26-1/2"		60.0	80.0	60.0	125.0	60.0	163.1	
37"		60.0	75.6	60.0	116.8	60.0	116.8	
42"		(4)	56.3	56.3	60.0	102.9	60.0	102.9
48"		37.0	37.0	60.0	90.1	60.0	90.1	
53-1/8"		-	-	60.0	81.4	60.0	81.4	
19-1/8"	50-5/8"	60.0	80.0	60.0	125.0	60.0	171.3	
26-1/2"		60.0	80.0	60.0	123.7	60.0	123.7	
37"		60.0	64.6	60.0	88.6	60.0	88.6	
42"		(5)	-	-	60.0	78.0	60.0	78.0
48"		-	-	60.0	68.3	60.0	68.3	
53-1/8"		-	-	60.0	61.7	60.0	61.7	
19-1/8"	59"	60.0	80.0	60.0	125.0	60.0	183.8	
26-1/2"		60.0	80.0	60.0	125.0	60.0	132.6	
37"		47.9	47.9	60.0	95.0	60.0	95.0	
42"		(6)	-	-	60.0	83.7	60.0	83.7
48"		-	-	60.0	73.2	60.0	73.2	
53-1/8"		-	-	60.0	64.0	60.0	66.2	
19-1/8"	63"	60.0	80.0	60.0	125.0	60.0	206.5	
26-1/2"		60.0	76.7	60.0	125.0	60.0	149.0	
37"		47.0	47.0	60.0	97.5	60.0	106.7	
42"		(7)	-	-	60.0	85.1	60.0	93.1
48"		-	-	60.0	71.9	60.0	75.8	
53-1/8"		-	-	60.0	62.7	60.0	65.4	
19-1/8"	74-1/4"	60.0	74.6	60.0	125.0	60.0	175.2	
26-1/2"		60.0	64.1	60.0	113.4	60.0	126.5	
37"		-	-	60.0	82.0	60.0	90.6	
42"		(7)	-	-	60.0	74.8	60.0	79.8
48"		-	-	60.0	65.5	60.0	69.8	
53-1/8"		-	-	58.0	58.0	60.0	60.0	
19-1/8"	76"	-	-	60.0	125.0	60.0	199.7	
26-1/2"		-	-	60.0	110.2	60.0	144.1	
37"		-	-	60.0	80.3	60.0	103.2	
42"		(7)	-	-	60.0	73.1	60.0	88.1
48"		-	-	60.0	64.5	60.0	69.9	

\* NO. IN PARENTHESIS INDICATE NO. OF ANCHORS PER JAMB.

NOTE:  
GLASS CAPACITIES ON THIS SHEET ARE  
BASED ON ASTM E1300-09 (3 SEC. GUSTS)  
AND FLORIDA BUILDING COMMISSION  
DECLARATORY STATEMENT DCA05-DEC-219

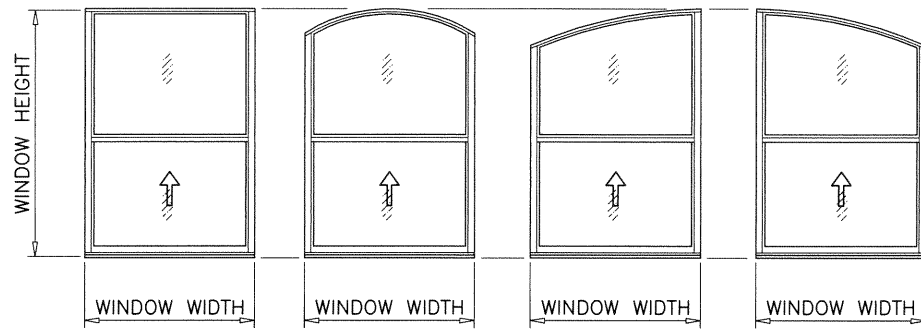

**APPROVED CONFIGURATIONS**

SHAPES SHOWN ABOVE OR SIMILAR

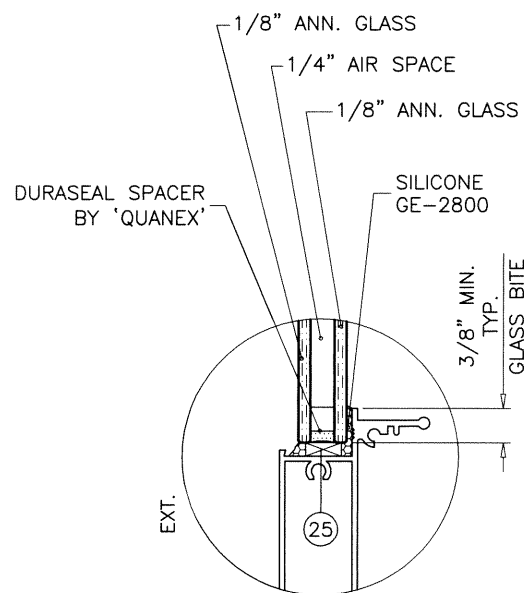
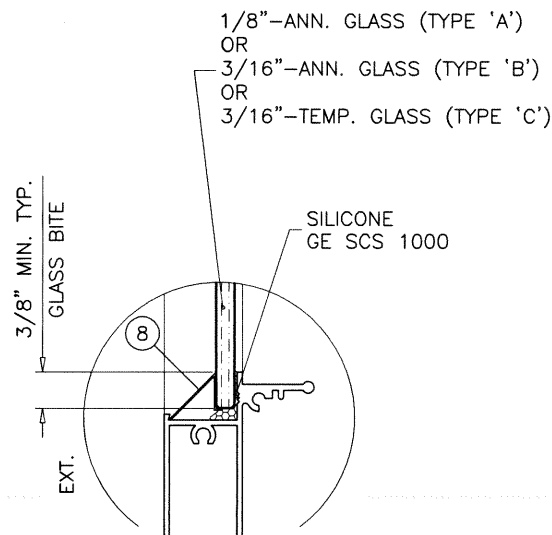

**GLASS TYPE 'E'**  
1/2" OVERALL INSUL. GLASS

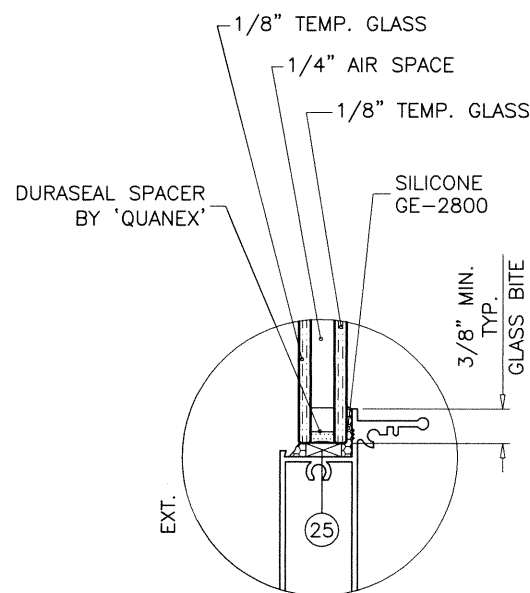

**GLASS TYPE 'D'**  
1/2" OVERALL INSUL. GLASS

**GLAZING OPTIONS**

DESIGN LOAD CAPACITY - PSF						
WINDOW DIMS.		GLASS TYPE 'E'		GLASS TYPE 'D'		
WIDTH	HEIGHT	EXT.(+)	INT.(-)	EXT.(+)	INT.(-)	
19-1/8"	26"	56.7	210.0	60.0	210.0	
26-1/2"		56.7	201.9	60.0	201.9	
37"		56.7	144.6	60.0	144.6	
42"		(3)	56.7	127.4	60.0	127.4
48"		56.7	111.5	60.0	111.5	
53-1/8"		56.7	100.7	60.0	100.7	
19-1/8"	38-3/8"	56.7	210.0	60.0	210.0	
26-1/2"		56.7	182.4	60.0	182.4	
37"		56.7	130.6	60.0	130.6	
42"		(4)	56.7	111.9	60.0	115.1
48"		56.7	94.4	60.0	100.7	
53-1/8"		56.7	83.3	60.0	90.9	
19-1/8"	50-5/8"	56.7	210.0	60.0	210.0	
26-1/2"		56.7	165.0	60.0	172.8	
37"		56.7	112.9	60.0	123.2	
42"		(5)	56.7	93.7	60.0	102.2
48"		56.7	77.8	60.0	84.8	
53-1/8"		56.7	67.9	60.0	74.1	
19-1/8"	59"	56.7	182.2	60.0	210.0	
26-1/2"		56.7	143.8	60.0	177.9	
37"		56.7	106.0	60.0	115.6	
42"		(6)	56.7	86.6	60.0	94.4
48"		56.7	70.9	60.0	77.4	
53-1/8"		56.7	61.5	60.0	67.1	
19-1/8"	63"	56.7	163.4	60.0	210.0	
26-1/2"		56.7	134.8	60.0	166.6	
37"		56.7	102.1	60.0	113.4	
42"		(7)	56.7	84.2	60.0	91.8
48"		56.7	68.5	60.0	74.7	
53-1/8"		56.7	59.1	60.0	64.5	
19-1/8"	74-1/4"	56.7	111.1	60.0	210.0	
26-1/2"		56.7	93.3	60.0	165.0	
37"		56.7	79.3	60.0	112.3	
42"		(7)	56.7	70.3	60.0	89.0
48"		56.7	63.6	60.0	70.6	
53-1/8"		55.0	55.0	60.0	60.0	
19-1/8"	76"	56.7	107.1	60.0	210.0	
26-1/2"		56.7	88.0	60.0	161.2	
37"		56.7	76.5	60.0	112.3	
42"		(7)	56.7	68.4	60.0	89.0
48"		56.7	61.3	60.0	70.4	

\* NO. IN PARENTHESIS INDICATE NO. OF ANCHORS PER JAMB.

Sealed: 1/29/2021

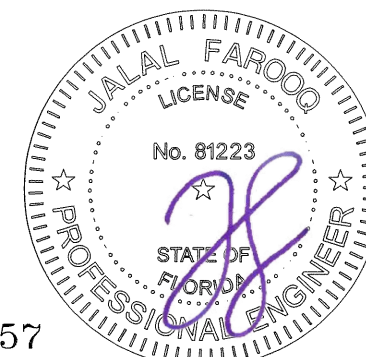

FL #21857



**AL-FAROOQ CORPORATION**  
ENGINEERS & PRODUCT DEVELOPMENT  
9360 SUNSET DRIVE, SUITE 220  
MIAMI, FLORIDA 33173 (C.A.N. 3538)  
TEL. (305) 262-6978 FAX. (305) 264-8100  
COMP-ANL\W17-19AWP

SERIES 580 ALUM SINGLE HUNG WINDOW (N.I.)  
**Assura Windows & Doors, LLC**  
d/b/a AWP Windows & Doors  
1543 N. Powerline Road  
Pompano Beach, FL 33069  
Tel. (305) 887-2646 Fax. (-)

revisions:	no	date	by	description
date:	02-13-17	scale:	1/2" = 1"	
dr. by:	TARIQ	chk. by:		
drawing no.	W17-19			
sheet	2 of 5			

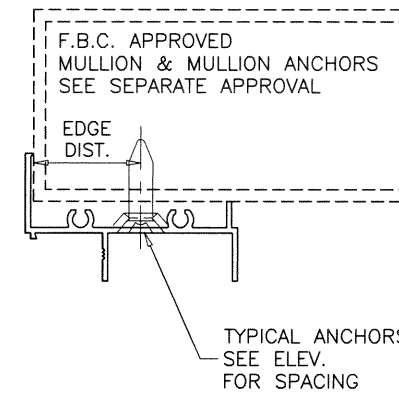
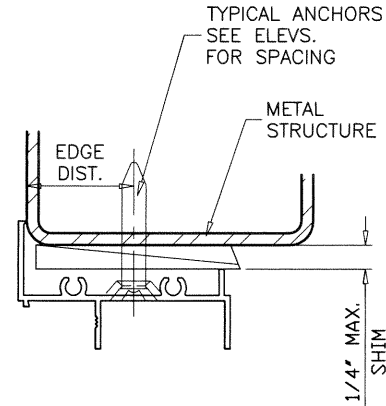
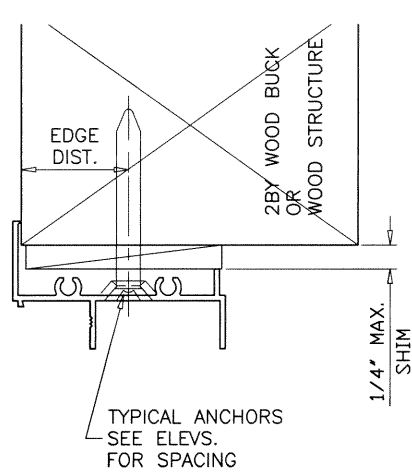
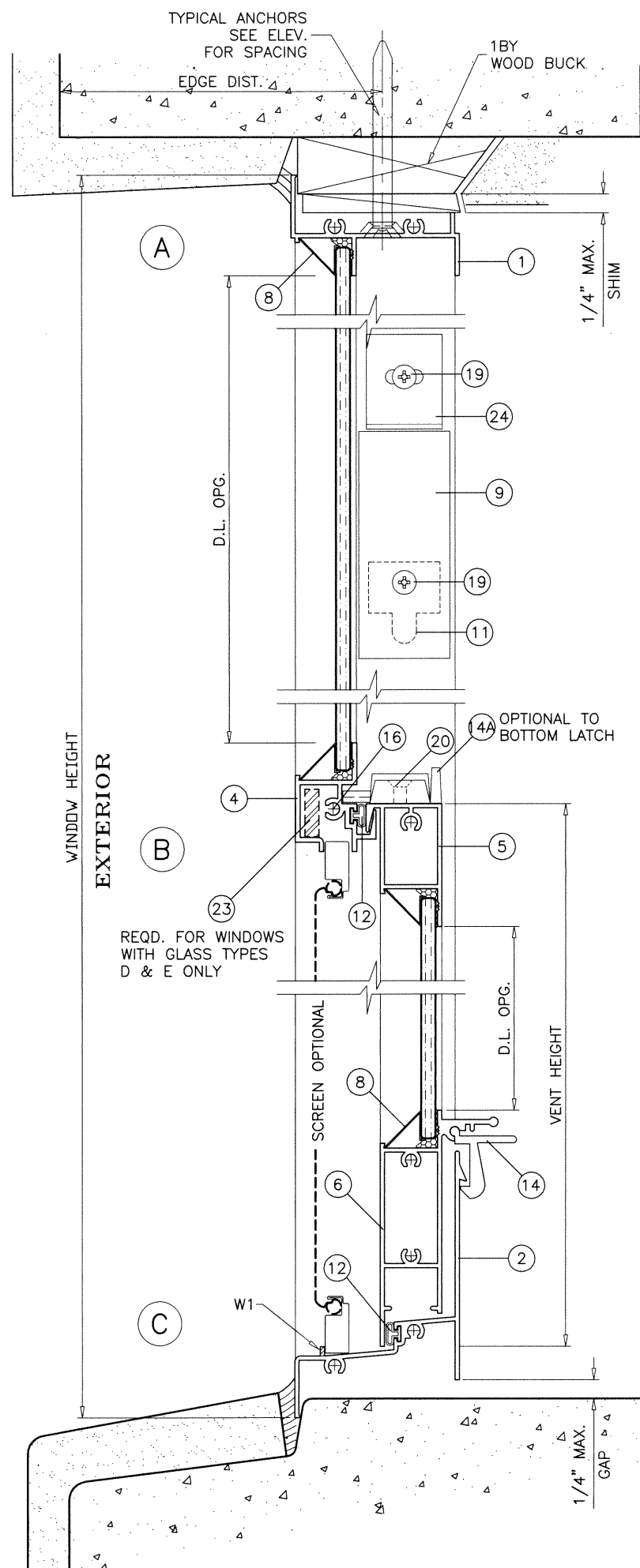

WOOD BUCKS AND METAL STRUCTURE NOT BY 'AWP WINDOWS' MUST SUSTAIN LOADS IMPOSED BY GLAZING SYSTEM AND TRANSFER THEM TO THE BUILDING STRUCTURE.

**TYPICAL ANCHORS:** SEE ELEV. FOR SPACING  
**1/4" DIA. TAPCON BY 'ITW'** (Fu=125 KSI, Fy=100 KSI)  
**1/4" DIA. ULTRACON+ BY 'DEWALT'** (Fu=164 KSI, Fy=148 KSI)  
 INTO 2BY WOOD BUCKS OR WOOD STRUCTURES  
 1-1/2" MIN. PENETRATION INTO WOOD (HEAD/JAMBS)  
 THRU 1BY BUCKS INTO CONC. OR BLOCKS  
 1-1/4" MIN. EMBED INTO CONCRETE (HEAD/JAMBS)  
 1-1/4" MIN. EMBED INTO BLOCKS (JAMBS)  
 DIRECTLY INTO CONCRETE OR BLOCKS  
 1-1/4" MIN. EMBED INTO CONCRETE (HEAD/JAMBS)  
 1-1/4" MIN. EMBED INTO BLOCKS (JAMBS)

**#12 TEKS OR SELF DRILLING SCREWS** (GRADE 5 CRS)  
 INTO F.B.C. APPROVED MULLIONS  
 OR  
 INTO METAL STRUCTURES (HEAD/JAMBS)  
 (3) THREADS MIN. PENETRATION BEYOND SUBSTRATE  
 ALUMINUM: 1/8" THK. MIN. (6063-T5 MIN.)  
 STEEL: 1/8" THK. MIN. (Fy = 36 KSI MIN.)  
 (STEEL IN CONTACT WITH ALUMINUM TO BE PLATED OR PAINTED)

**TYPICAL EDGE DISTANCE**  
 INTO CONCRETE AND MASONRY = 2" MIN.  
 INTO WOOD STRUCTURE = 1" MIN.  
 INTO METAL STRUCTURE = 1/2" MIN.

WOOD AT HEAD OR JAMBS SG = 0.55 MIN.  
 CONCRETE AT HEAD, SILL OR JAMBS f'c = 3000 PSI MIN.  
 C-90 HOLLOW/FILLED BLOCK AT JAMBS f'm = 2000 PSI MIN.

**SEALANT:**

ALL LOWER FRAME AND VENT CORNERS, AND HEADS OF INSTALLATION SCREWS AT SILL TO BE SEALED WITH ALUMINUM COLORED SEALANT, SCHNEE MOREHEAD 5504 OR EQUIV.

**PADS:**

ONE 1/4" X 3/4" ADHESIVE CLOSED CELL FOAM PAD AT EACH END OF FIXED MTG. RAIL.

**WEEPHOLES:**

W1 = 3/4" WEEP NOTCH AT EACH END

Sealed: 1/29/2021

FL #21857

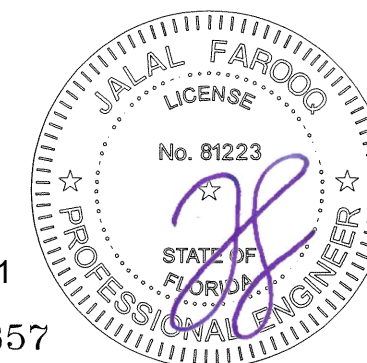

**af c**  
**AL-FAROOQ CORPORATION**  
 ENGINEERS & PRODUCT DEVELOPMENT  
 9360 SUNSET DRIVE, SUITE 220  
 MIAMI, FLORIDA 33173 (C.A.N. 3538)  
 TEL. (305) 264-8100 FAX. (305) 262-6978  
 COMP-ANL W17-19AMP

SERIES 580 ALUM SINGLE HUNG WINDOW (N.I.)  
**Assura Windows & Doors, LLC**  
 d/b/a AWP Windows & Doors  
 1543 N. Powerline Road  
 Pompano Beach, Fl. 33069  
 Tel. (305) 887-2646 Fax. (-)

no	date	by	description

date: 02-13-17  
 scale: 1/2" = 1"  
 dr. by: TARIQ  
 chk. by:

drawing no.  
**W17-19**  
 sheet 3 of 5

ITEM #	PART #	REQD.	DESCRIPTION	MATERIAL	MANF./SUPPLIER/REMARKS
1	YE-169	1	FRAME HEAD	6063-T6	-
2	YE-167	1	FRAME SILL	6063-T6	-
3	YE-102	2	FRAME JAMB	6063-T6	-
4	YE-152	1	FIXED RAIL	6063-T6	-
5	YE-151	1	VENT TOP RAIL	6063-T6	-
6	YE-168	1	VENT BOTTOM RAIL	6063-T6	-
7	YE-92	2	VENT JAMB	6063-T6	-
8	-	AS REQD.	GLAZING BEAD	ALUMINUM	ROLL FORMED
9	YH-528	2/ VENT	SASH STOP, 3" LONG	RIGID VINYL	-
10	-	2/ VENT	BLOCK & TACKLE BALANCE	-	-
11	YH-505	2/ VENT	BALANCE CLIP	ALUMINUM	-
12	YH-622	AS REQD.	BULB W'STRIPPING	VINYL	SINGLE ROW
13	YH-4004	AS REQD.	FIN SEAL W'STRIPPING .187 X .250	WOOL	ULTRAFAB
14	YH-504	2/ VENT	SPRING LOADED VENT LATCHES	NYLON/CELCON	AT 13" FROM ENDS
14A	YH-515	2/ VENT	SWEEP LOCKS	ZAMAK	AT 11" FROM ENDS
15	YF-1	8	FRAME ASSEMBLY SCREWS (#10 X 3/4")	CRS	PLATED, PH SMS
16	YF-10	2/ VENT	FIXED RAIL SCREWS (#8 X 1")	CRS	CAD PLATED, PH SMS
17	YF-12	6/ VENT	VENT ASSEMBLY SCREWS (#8 X 1-1/4")	CRS	CAD PLATED, PH SMS
19	YF-6	1/ CLIP	#10 X 1/4" PH SMS POINT B	-	-
20	YF-14	2/ LOCK	SWEEP LOCK SCREWS (#8 X 5/8")	-	OH SMS
21	YC-15SP	2/ VENT	SELF ADHESIVE PAD (.375" X .31" X .75")	FOAM	-
22	YH-519	2/ VENT	BALANCE CAM	PLASTIC	-
23	YH-590	1	REINFORCING BAR (REQD. FOR INSUL. GLASS ONLY)	STEEL	HRB93
24	-	2/ VENT	SASH STOP (1" X 1-1/4" X 1/16")	ALUMINUM	ON 74-1/4" HIGH ONLY
25	-	2/ LITE	SETTING BLOCK	EPDM	DUROMETER 80±5 SHORE A

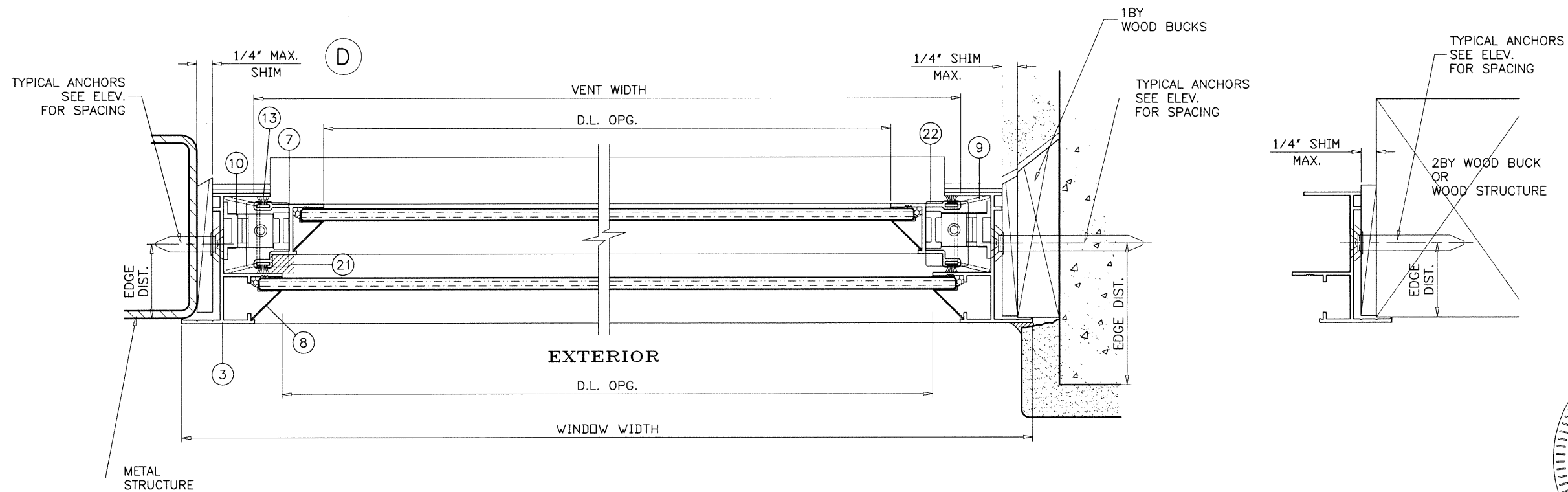
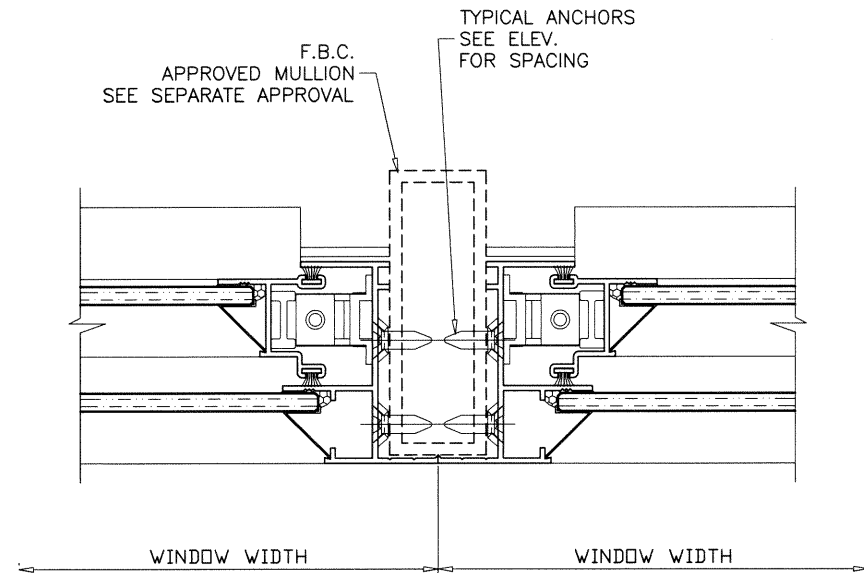

Sealed: 1/29/2021

FL #21857

**af c**  
**AL-FAROOQ CORPORATION**  
 ENGINEERS & PRODUCT DEVELOPMENT  
 9360 SUNSET DRIVE, SUITE 220 (C.A.N. 3638)  
 MIAMI, FLORIDA 33173 FAX. (305) 262-6978  
 TEL. (305) 264-8100

SERIES 580 ALUM SINGLE HUNG WINDOW (N.I.)

Assura Windows & Doors, LLC  
 d/b/a AWP Windows & Doors  
 1543 N. Powerline Road  
 Pompano Beach, FL 33069  
 Tel. (305) 887-2646 Fax. (-)

no	date	by	description

date: 02-13-17  
 scale: 1/2" = 1"  
 dr. by: TARIQ  
 chk. by:

drawing no.  
**W17-19**  
 sheet 4 of 5

COMP-ANL\W17-19AWP

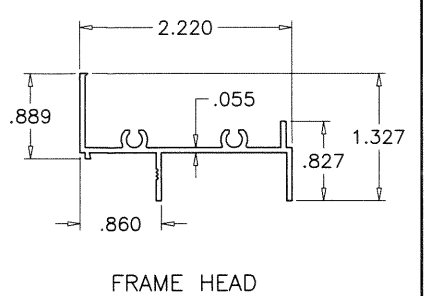

FRAME HEAD

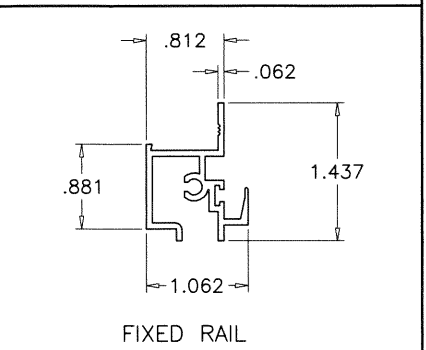

FIXED RAIL

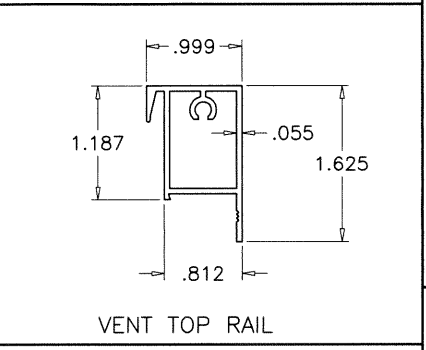

VENT TOP RAIL

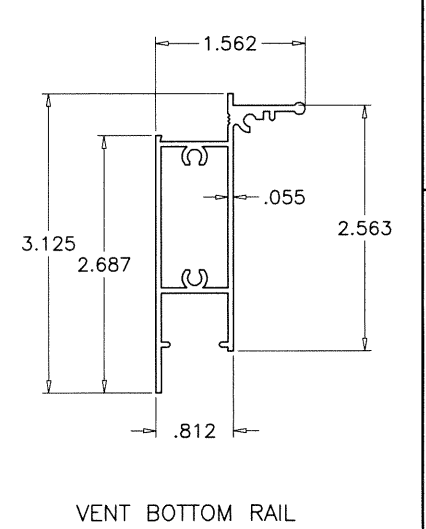

VENT BOTTOM RAIL

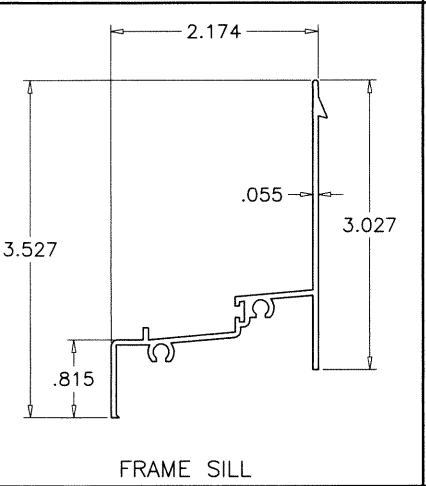

FRAME SILL

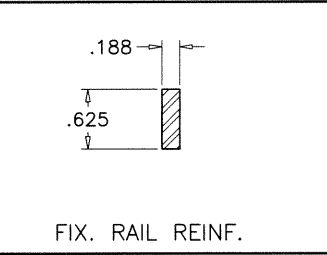

FIX. RAIL REINF.

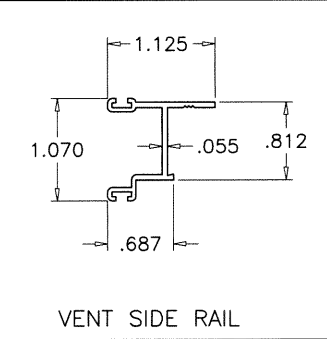

VENT SIDE RAIL

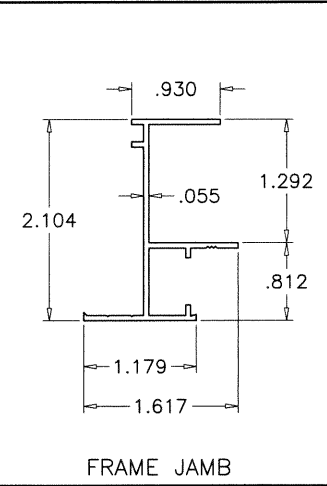

FRAME JAMB

3/4" WEEP NOTCH  
AT EACH END OF  
SCREEN RETAINING LEG

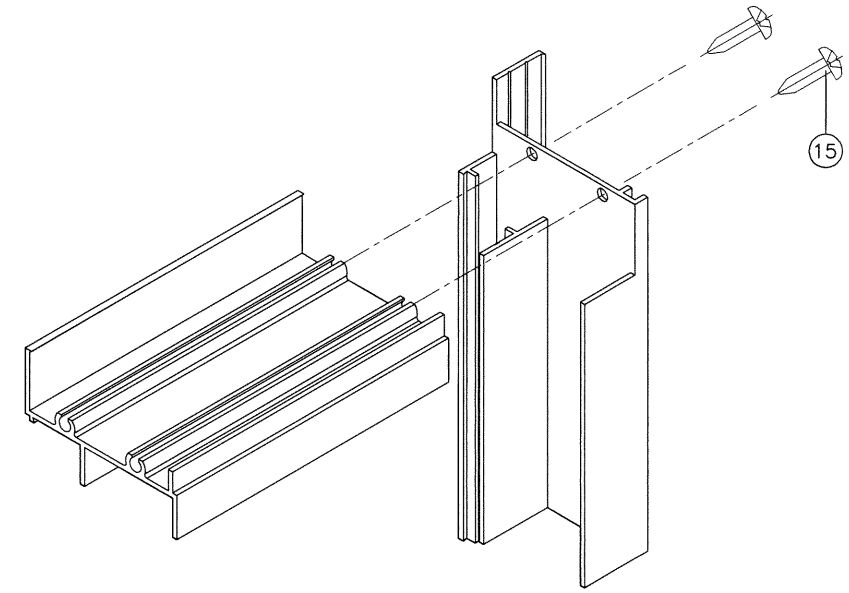

S.H. FRAME CORNER DETAIL

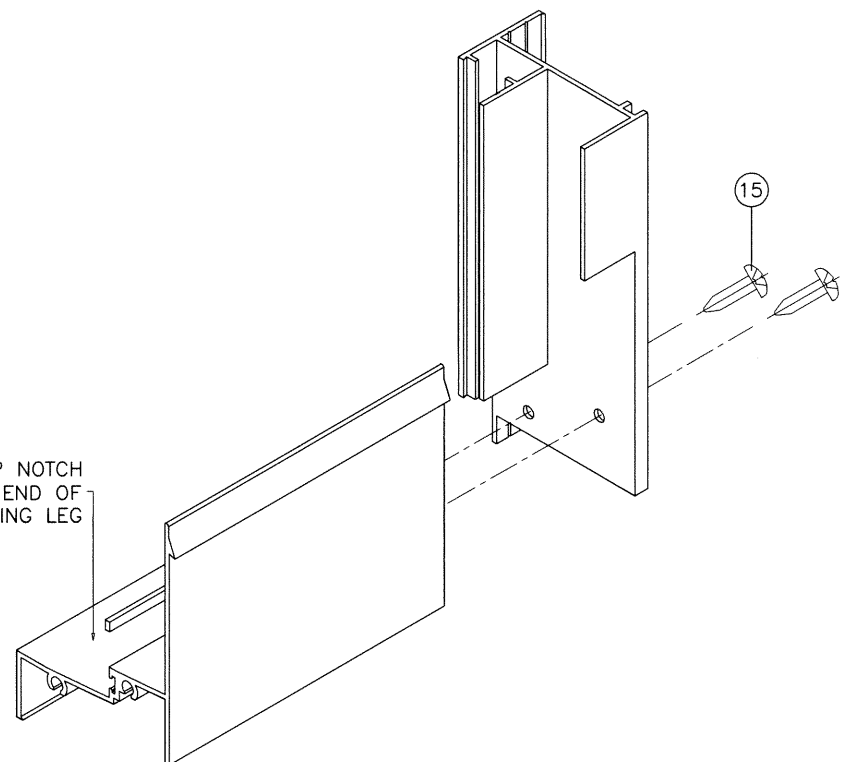

S.H. VENT CORNER DETAIL

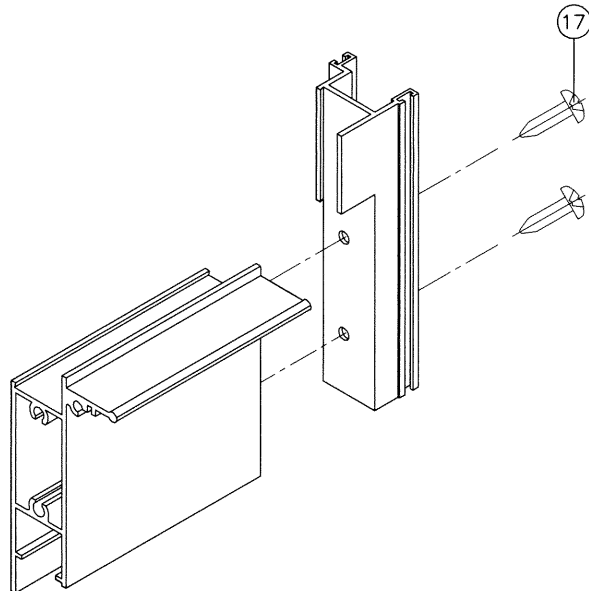
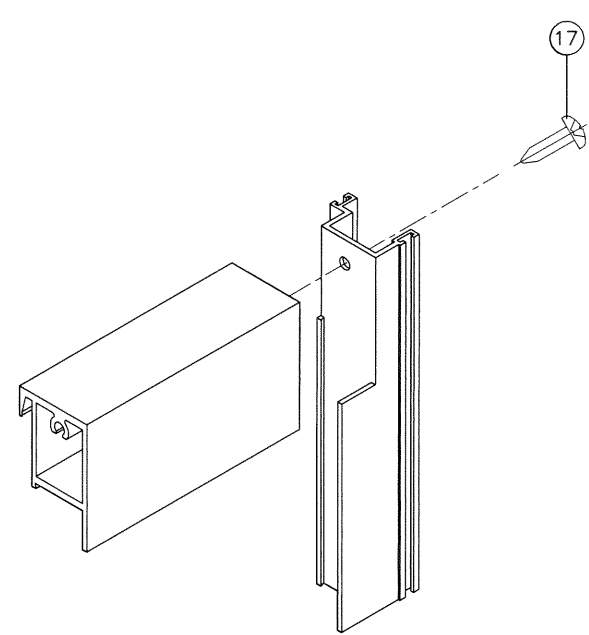

Sealed: 1/29/2021

FL #21857



**afc**  
**AL-FAROOQ CORPORATION**  
 ENGINEERS & PRODUCT DEVELOPMENT  
 9360 SUNSET DRIVE, SUITE 220  
 MIAMI, FLORIDA 33173 (C.A.N. 3538)  
 TEL. (305) 264-8100 FAX. (305) 262-6978  
 COMP-ANL W17-19AWP

SERIES 580 ALUM SINGLE HUNG WINDOW (N.I.)  
**Assura Windows & Doors, LLC**  
 d/b/a AWP Windows & Doors  
 1543 N. Powerline Road  
 Pompano Beach, Fl. 33069  
 Tel. (305) 887-2646 Fax. (-)

no	date	by	description

date: 02-13-17  
 scale: 1/2" = 1"  
 dr. by: TARIQ  
 chk. by:

drawing no.  
**W17-19**  
 sheet 5 of 5